

21. November 2019

DALLMER**self-closing flap-valve S 10/12, d: 108,5 mm**

Product No. **495846**
 EAN: 4001636495846
 Discount group: 3

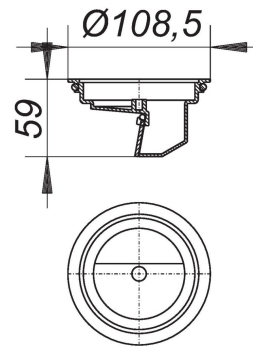

for use with floor drain PRONTO in place of trap insert (except for PRONTO K Alu), gratings and frames series 10 with 120 x 120 mm or with d: 120 mm, and for frames type SES 10/ECS 12.

Used on combined foul and rainwater systems, the flap-valve allows water to drain whilst preventing the escape of foul air and foam.

With no water seal, it cannot freeze!

specification:
 - self-closing flap

material:
 ABS

Product No.	Description	Dimensions
700339	floor drain PRONTO K Alu, DN 100, 120 x 120 mm	DN 100, 120 x 120 mm
700360	floor drain PRONTO K, DN 100, 120 x 120 mm	DN 100, 120 x 120 mm
700384	floor drain PRONTO K, DN 125, 120 x 120 mm	DN 125, 120 x 120 mm
700391	floor drain PRONTO K, secured, DN 100, 120 x 120 mm	DN 100, 120 x 120 mm
700063	floor drain PRONTO, DN 100, 120 x 120 mm	DN 100, 120 x 120 mm
700087	floor drain PRONTO, DN 125, 120 x 120 mm	DN 125, 120 x 120 mm
495341	frame ECS 12, 304 stainless steel, 120 x 120 mm	120 x 120 mm
495334	frame ER 12, 304 stainless steel, d: 120 mm	d: 120 mm
500601	frame S 15/120	d: 120 mm
495259	frame SES 10, 150 x 150 mm	150 x 150 mm

21. November 2019

DALLMER

495426	frame V, S 10/120, 304 stainless steel, 120 x 120 mm	120 x 120 mm
495419	Frame V, S 15/120, 120 x 120 mm	
495433	Frame V, S 15/d: 120 mm	d: 120 mm
510198	grating DER S 10/120, 120 x 120 mm	
510310	grating E 12, 120 x 120 mm	120 x 120 mm
510327	grating EN 12, secured grate, 120 x 120 mm	120 x 120 mm
510334	grating ER 12, d: 120 mm	d: 120 mm
510365	grating Quadra S 10/120, 120 x 120 mm	
510105	grating SEC 10, 150 x 150 mm	150 x 150 mm
510136	grating SEN 10, secured grate, 150 x 150 mm	150 x 150 mm