

21. October 2019

shower trap body ORIO, DN 50

Product No. 160010
EAN: 4001636160010
Discount group: 1

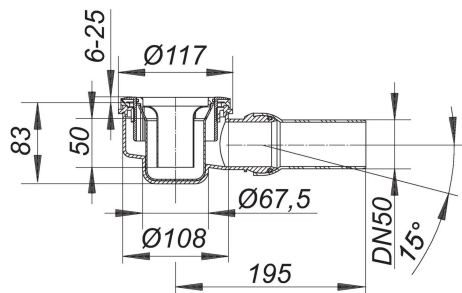

conforming to DIN EN 274
with build-in height only 85 mm, for shower trays with a 90 mm outlet

- specification:
- outlet horizontal, with ball-joint, adjustable 0 – 15 degrees
 - trap insert, removable for cleaning
 - temporary blanking plate/installation key

material:
polypropylene

The outlet connector can be supplied in ABS to suit British Standard sizes and PE-HD conforming to DIN EN 1519. Please enquire.

Other colours on request.

Flow rate tested to DIN EN 274
(with 15 mm water over grate)

| | Norm | DALLMER |
|-------|---------|----------|
| DN 50 | 0.4 l/s | 0.54 l/s |

| Product No. | Description | Dimensions |
|-------------|------------------|------------|
| 160683 | trap insert ORIO | |

21. October 2019

DALLMER

| Product No. | Description | Dimensions |
|-------------|--|------------|
| 160812 | raised grid ORIO, ABS chromed | |
| 160829 | raised grid ORIO, ABS white | |
| 160706 | raised grid ORIO, stainless steel | |
| 160720 | raised grid ORIO, stainless steel, design football | |